



PRIME EASTCHESTER RETAIL FOR LEASE

750 SF Plus Basement | \$3,100/Month Modified Gross

- Located in the heart of Eastchester's main shopping street
- Built-out as hair salon; move-in condition
- Tenant parking behind building
- Nearby busy signalized intersection
- Across from Village Hall

TRAFFIC COUNT:
NEARLY 15,000 VEHICLES PER DAY

NEARBY RETAILERS INCLUDE:



By Radius	1-Mile	3-Mile	5-Mile
Average HH Income	\$163,004	\$167,013	\$132,942
Median HH Income	\$107,847	\$109,942	\$84,295
Population	18,431	159,472	510,682
Total Households	7,307	62,270	193,168
Retail Potential	\$485M	\$4.3B	\$10.8B

CALL OWNER'S EXCLUSIVE AGENT: HARYN INTNER 914-779-8200 x123 HARYN@ADMIRALREALESTATE.COM

BROKERS PROTECTED

SITE PLAN

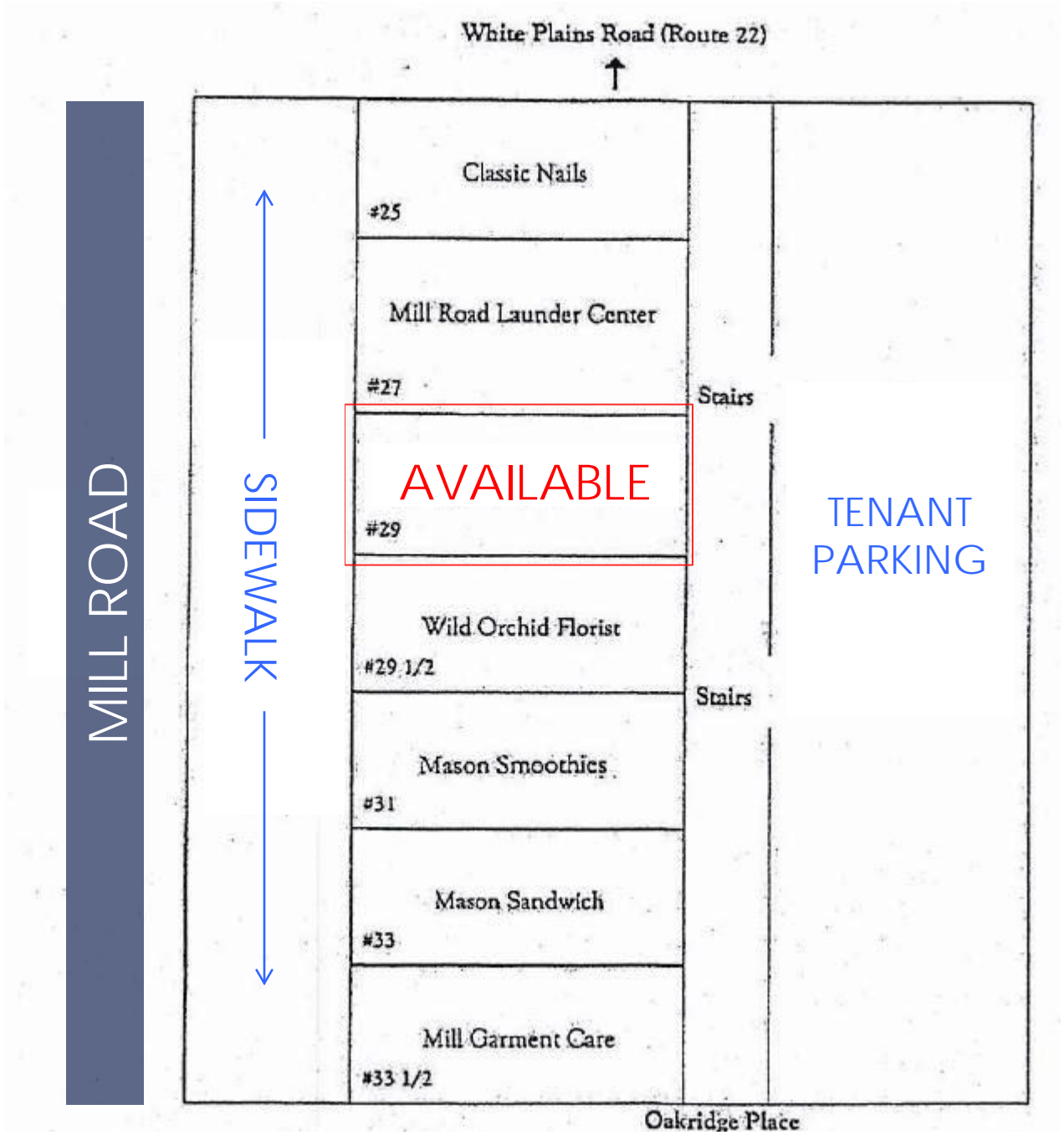

CALL OWNER'S
EXCLUSIVE AGENT:

HARYN INTNER 914-779-8200 x123 HARYN@ADMIRALREALESTATE.COM

BROKERS
PROTECTED



CLOSE-UP MAP



CALL OWNER'S
EXCLUSIVE AGENT:

HARYN INTNER 914-779-8200 x123 HARYN@ADMIRALREALESTATE.COM

BROKERS
PROTECTED

ADMIRAL REAL ESTATE SERVICES CORP. 62 Pondfield Rd Bronxville, NY 10708 Jonathan H. Gordon, Corporate Broker admiralrealestate.com

All information furnished regarding property for sale or rental is from sources deemed reliable, but no representations or warranties, express or implied, are made as to the accuracy thereof.

MAJOR RETAILER MAP



CALL OWNER'S
EXCLUSIVE AGENT:

HARYN INTNER 914-779-8200 x123 HARYN@ADMIRALREALESTATE.COM

BROKERS
PROTECTED